

OUR SOLUTIONS

# OUR SOLUTIONS

FOR EACH STAGE OF YOUR PROCESS



“

The world of correspondence is changing and the success of your operations now depends on more than just your sorting performance. That's why we are introducing our made-to-measure solutions in order to optimise your investments, reduce operational costs and increase the competitiveness of your business.

Well known for our expertise in postal automation, over time we have used this expertise to develop services that are complementary to mail sorting.

Today, our product range is organised around five areas, which are the five key points in the life cycle of your business: CONSULT, DESIGN, IMPLEMENT, SUPPORT and ADD VALUE,... behind each of these actions, you will discover a multitude of SOLYSTIC services.

”

# CONSULT

## How can your current operations be analysed?

### **AUDIT, PROCESS AND TECHNOLOGY ANALYSIS**

We look at all of your existing operations in terms of mail flows and data flows, type of equipment and associated operational methods, organisation, etc. We add value to strong points and identify areas in which progress can be made.

### **BENCHMARKING**

We enable you to look at the efficiency of your process in relation to areas where improvements can be made and then steer you towards new solutions.

### **INNOVATION CONSULT**

We have the right proposals to support you in your major projects. Based on a review of the existing infrastructure, we propose the best choices by integrating the right technologies and organisation for your needs and the needs of your own customers.



*Audit, process and technology analysis*



*Benchmarking*



*Innovation consult*



“

Our partnership with all operators has enabled us to acquire an in-depth understanding of the business and we know that the economic and competitive environment drives your strategic decisions. We can help you in the audit and analysis phases in order to advise you on the most suitable solution to help you achieve your objectives. Our combination of expertise and innovation means that we can design and deliver the solutions of tomorrow.

”

# DESIGN

## How can we work with you to define the best solution?

### PROCESS ENGINEERING

Your requirements are broken down into sub-assemblies and elementary interactions in order to provide you with a response to help achieve your final objective.

### SIZING

We identify the size of the solution in order to adapt each element of the process to your requirements: organisation, space, human resources, volumetry of operations, equipment, etc.

### MODELLING AND SIMULATION

All flows are analysed in a single model. Based on current and future operational conditions, all scenarios are envisaged and any exceptions are identified. Technical choices are thereby validated and performance tests are carried out on all of the systems.

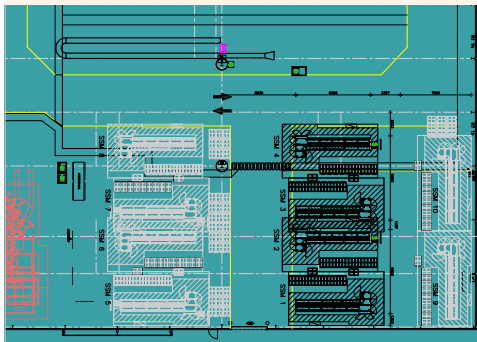

*Sizing*

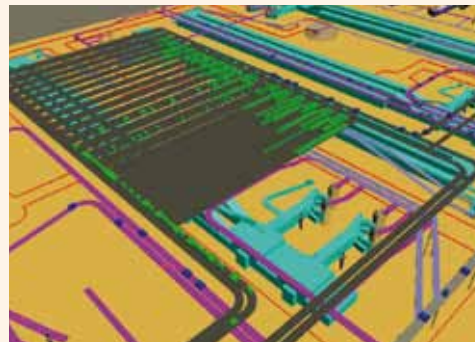

*Modelling*



*Simulation*

A blurred background image showing a group of people in a meeting or collaborative work environment. The colors are warm, dominated by oranges and yellows, with some darker tones. The people are out of focus, but their forms and interactions are visible.

“

Because each project is unique, we carry out our design by working alongside your experts. Based on an architecture which we define together, we design, simulate and finalise how your solutions will work. Our modelling and simulation tools enable us to analyse how our solutions will work before they are implemented, in order to validate their sizing, efficiency and impact on the organisation.

”

# IMPLEMENT

## How can the success of your project be guaranteed?

### MAIL SORTING AND SEQUENCING SOLUTIONS

A market leader in the sorting of letters and flat mail pieces, SOLYSTIC has established itself amongst the main postal operators with its STAR, TOP 2000 and MARS machines.

### IDENTIFICATION AND CODING

Our solutions benefit from more than 30 years of expertise in address interpretation. From reading codes to the full processing of information on mail objects, all of the data present on mail pieces are recognised.

### INFORMATION SYSTEMS - IS

The IS is a management tool which generates the information required for production (sort plans, address files, etc.), collects operating data in real time and provides personalised reports. Thanks to its progressive architecture, it can be used for controlling and monitoring a sorting centre or a complete national network; it can be integrated into an existing IT system.

### TURNKEY SOLUTIONS

We offer you personalised solutions and the management of their complete implementation. We guarantee the coherence of the solution.

### FINANCING AND PARTNERSHIP

In order to implement your new projects, we can offer you financing and partnership solutions.



Mail sorting solutions



Sequencing



Identification & coding

“

From purchasing equipment to installing a turnkey solution, SOLYSTIC is able to respond to all of your requirements. Our sorting and sequencing solutions, in operation across the world, are constantly evolving. Our specialists create effective solutions for interpreting and coding the information on mail objects. Our expertise is also available to you for the implementation of information systems, designed to improve efficiency and increase productivity throughout the sorting network. As a comprehensive service provider, we are able to deliver project management for turnkey solutions, covering everything from a sorting centre to the creation of a complete network. To achieve this, we work with your suppliers and where appropriate, work with local partners. Our solutions are sustainable and proven in numerous operators.

”

# SUPPORT

How can the performance of your project be maintained?

## MAINTENANCE AND TECHNICAL SUPPORT

Our teams will support you throughout the life cycle of your equipment. Experts are dedicated to overseeing your contract. Our services are tailored to suit the level of support required.

## SPARE PARTS

Working together, we can optimise costs and commit to annual targets.

## SUPERVISION

Tools are available for you to optimise maintenance operations and work proactively. The easy-View web monitoring service helps to monitor all of your systems, in real time remotely, via a tablet or smartphone.

## TRAINING AND COACHING

Our training is provided by teams with an understanding of operations in the field. We also provide support during the implementation of a change in operations.

## OVERALL EQUIPMENT EFFICIENCY MEASURE

Our OEE (Overall Equipment Efficiency) solutions enable you to measure the efficiency of your equipment in a simple, clear and regular way.

## PROCESS OPTIMISATION

We supply advice and suggest the necessary improvements to help you turn the solutions you use to your best advantage.

## SERVICE LEVEL AGREEMENT - SLA

We manage the maintenance of your process and commit to achieving a certain service level.



Technical support



Supervision – easy-View



Training

“

Our work continues even after the delivery of our solutions. We can provide support from the familiarisation period, all through the systems planned life and beyond. From operator training to overall maintenance services, each of our services is supplied by teams of specialists with a great deal of experience in the field. They ensure that the performance of your equipment is optimised.

”

# ADD VALUE

## How can your operational performance be maximised?

### PERFORMANCE IMPROVEMENTS

All the solutions you use on a daily basis are likely to be improved. Increase in operational throughput, increasing the spectrum of objects processed, improvements in reading rates, development of new tools, etc.

### VALUE ADDING INNOVATIONS

Our virtual identification concept (V-Id™) enables the sorting and monitoring of mail pieces without perturbing them by adding printing. Other functions, in particular

concerning the detection of envelope attributes, have been designed for integration in equipment that is already in use. These bring an immediate benefit, when it comes to revenue protection for example: monitoring franking, pre-payment, extended customer code, etc.

### OUTSOURCING

Thanks to SOLYSTIC, you can outsource certain stages of your processes in order to reduce costs and concentrate on your core business.

### MULTI-CHANNEL COMMUNICATION

The new services expected by your customers require an electronic link for greater interaction. MailEbox is one example of this.

### SUSTAINABLE DEVELOPMENT

By associating technological upgrades, in particular electro-mechanicals, with optimisations made to our equipment, we have reduced the energy consumption of the solutions we implement. For example, the use of V-Id™ means there is no longer any need for inks and solvents, identification labels, etc.



Performance improvements – e-learning



Outsourcing – Videocoding



Multi-channel communication – MailEbox

“

Reducing operating costs, enhancing performance, improving operator comfort, process reorganisation, technological advancements... all these criteria and many more besides provide the basis for our suggestions for making improvements.

We take into account market developments and the diversity of our various customers' requirements in order to channel each of them towards the best-performing solutions.

”

Helping you make a success of your projects,  
that's our job...





SOLYSTIC SAS  
14, avenue Raspail  
94257 Gentilly CEDEX  
France  
Tel: +33 (0)1 49 69 41 00  
Fax: +33 (0)1 45 47 82 20

SOLYSTIC SAS  
25, rue de Chony  
BP 102  
26501 Bourg-lès-Valence CEDEX  
France  
Tel: +33 (0)4 75 40 71 00  
Fax: +33 (0)4 75 40 71 30

SOLYSTIC BELGIUM N.V.  
Prins Boudewijnlaan 17 - Unit 5  
2550 Kontich  
Belgium  
Tel: +32 (0)3 444 04 10  
Fax: +32 (0)3 444 04 24

SOLYSTIC SHANGHAI  
Representative Office - Room 3012  
N° 2525 Zhong Shan Road  
Shanghai 200030  
China  
Tel: +86 21 3425 0208  
Fax: +86 21 6439 1722

[www.solystic.com](http://www.solystic.com)



**FOR MORE INFORMATION**  
[www.solystic.com](http://www.solystic.com)  
[contact.sales@solystic.com](mailto:contact.sales@solystic.com)  
Tel : +33 (0)1 49 69 41 00

